

# KTI SA2G GPS 406 MHz PLB

## Extract from user manuals

### INSTRUCTIONS FOR USE

The Safety Alert SA2G was designed to be operated on the ground or above the ground.

#### To Activate:

1. Slide RED protective cover downwards to access button.
2. Release antenna end-lock by sliding forward and set antenna to vertical position. (Fig. 1 & 2)
3. Press & hold RED Activation button until Green light starts flashing then release button. (Strobe light will also flash) (Fig.3)
4. Place in a clear area with antenna in vertical position or place above the ground. ie. If held by operator (ensure antenna is in the vertical position). (Fig.4).
5. Leave beacon operating continuously until rescued.

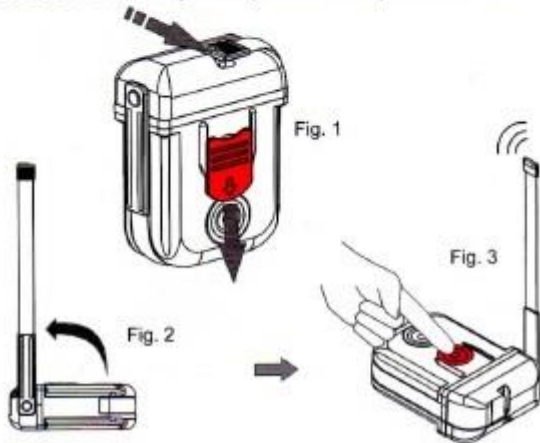

### INSTRUCTIONS FOR USE

On the ground

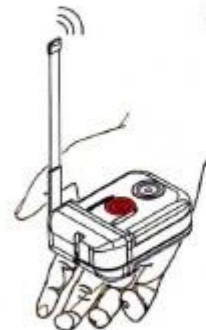

Fig. 4

Held by operator

### DEACTIVATING THE BEACON

1. Slide red protective cover back over the Red button to prevent reactivation of the beacon (secure with tape if necessary).
2. Press Blue "Test" button until the strobe light ceases flashing.
3. Wrap antenna around the beacon to its original position and secure the end of the antenna in the recessed area on the top of the beacon.