

McMurdo Fastfind / Kannad Safelink Solo GPS 406 MHz PLB

Extract from user manuals

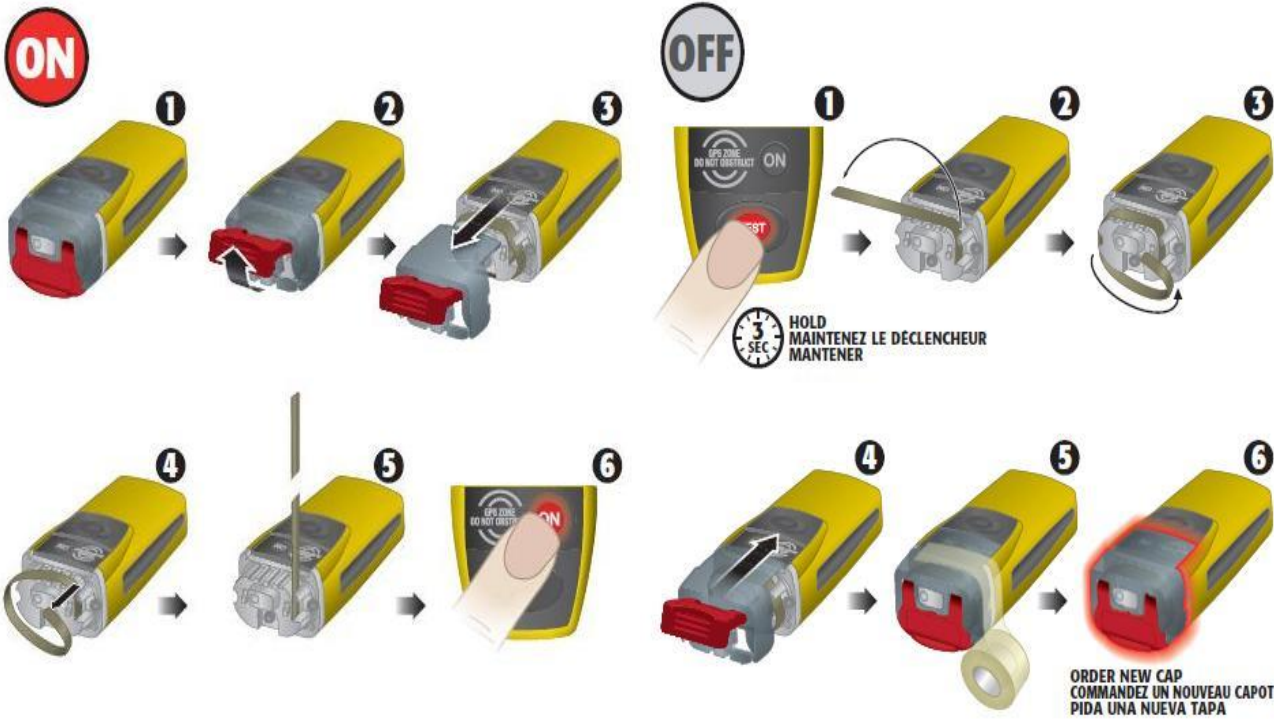

Indicator Light

As soon as the PLB is activated, the indicator light will start to flash:

- Two flashes every second indicates the unit is activated and is attempting to acquire a GPS position fix.
- One flash every 3 seconds indicates that a GPS position fix has been acquired.
- A long flash followed by three rapid flashes every 50 seconds indicates that the PLB has transmitted a distress signal along with the current GPS position.

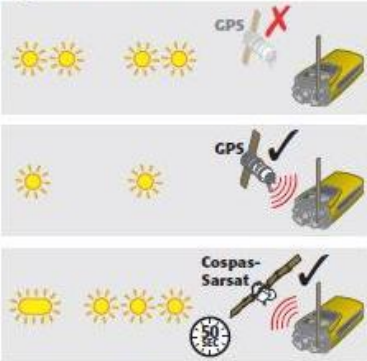

While the PLB is active, pressing the **ON** button again will cause the indicator light to flash a Morse code SOS pattern. This can be used to attract attention in low light conditions. The SOS pattern is repeated four times each time **ON** is pressed.

NOTE: To conserve battery life a maximum of 30 presses is allowed, after which this feature is disabled.

